

Feel The Passion

THE FORUM AT MUNDO IMPERIAL

Preliminary Technical Guide / Subject to change



EXPO•FORUM•RESORT•SPA•PROMENADE



Bld. de las Naciones & Blvd. Barra Vieja
Acapulco, Gro., Mexico 39900

Feel The Passion



Entertainment in Mexico will never be the same. With a seating capacity for up to 4,000 people, the Forum at Mundo Imperial creates an intimate atmosphere where no spectator will be farther than 35m away from the stage.

The Forum at Mundo Imperial is located in the most exclusive area in Acapulco – Acapulco Diamante. In the Forum at Mundo Imperial, patron comfort is assured – boasting luxury suites, valet parking and a VIP Lounge.

Luxury and comfort are not only featured in the building facade, but also in its state-of-the-art technology and acoustically tuned design, factors that will surely make every presentation an unforgettable experience.

Welcome to the Forum at Mundo Imperial

The Forum at Mundo Imperial was created to satisfy the demands of a modern Mexico that has an avid and knowledgeable public in search of international events, as well as to satisfy the expectations of all the Mexican Pacific Southwest.

With a forefront design and high-tech features, the Forum at Mundo Imperial will make every live performance a memorable experience. Its great isoptic and extraordinary acoustic will please the most demanding audience.

With an investment of more than \$45 million dollars, the Forum at Mundo Imperial is a first class Entertainment Center with more than 193,000 sq. ft. of construction, designed specifically for concerts, plays, sporting events, and conventions among others.

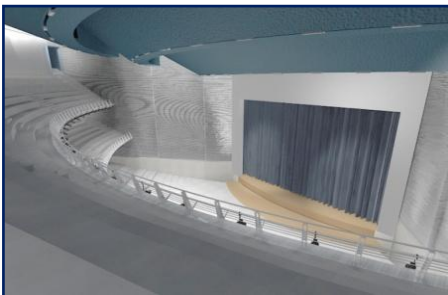

Introduction

Our venue is part of Mundo Imperial: a mega-development conformed by a Resort, a Convention Center, a Promenade, a Spa and of course an Entertainment Center – which together creates an integral concept that combines entertainment, business, hospitality and luxury.

Its audience capacity may vary between 2,800 and 4,000 seats depending on the stage setup. Emotion and intimacy will make a success out of every event. Not only **will each spectator see their favorite performer, they'll feel them** - up close and personal.

Because of its splendid tropical climate and beautiful beaches, Acapulco has always been renowned as one of the main destinations Mexico has to offer, and now it will be home to Mundo Imperial, where fun and entertainment will rise to a new level of quality in live performances.

The Forum at Mundo Imperial is managed by SMG, the world leader in facility management, marketing and development. Combining recognized industry leadership and management expertise with more than 28 years experience in successful facility management to provide the finest services, the greatest entertainment, and the most positive customer experience for the buildings they manage across the United States and around the world.

SMG manages Stadiums, Arenas, Convention Centers, and Theaters the world over. Providing top notch booking, marketing and sales, construction and operations consultation as well as operations development.



Seating Chart

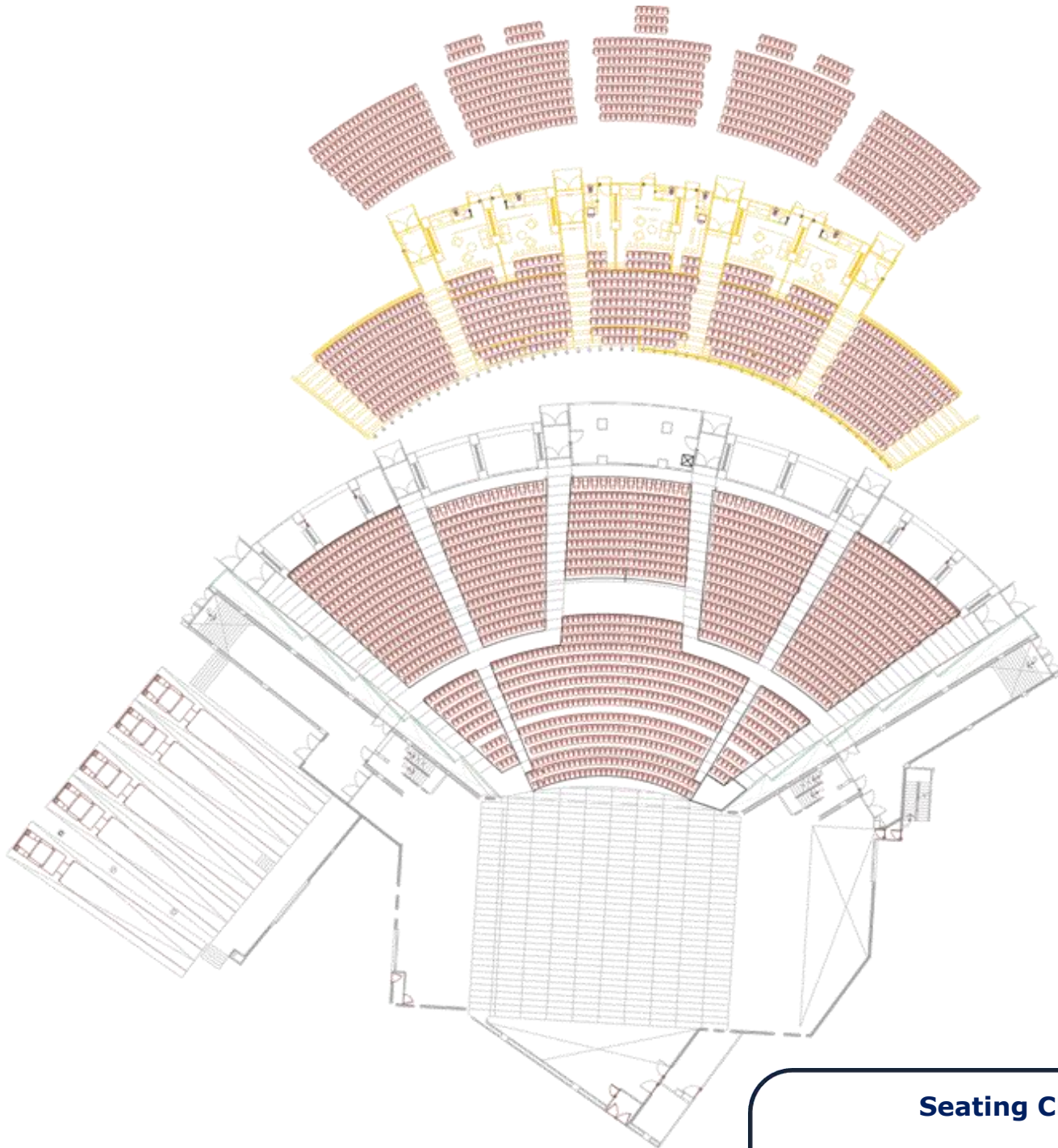

Seating Chart

Main Level	1992
Club Level	1011
Upper Level	1050
Total	4053

Technical Specs

Backstage

Loading dock

Westside of theatre ramp: 18m wide and 27.9m high. Approximately 48m from curb
Doors 5 x 4m

Wardrobe

Location: One level above stage

1 Washing machine

1 Dryer

1 Steam dryer in wardrobe

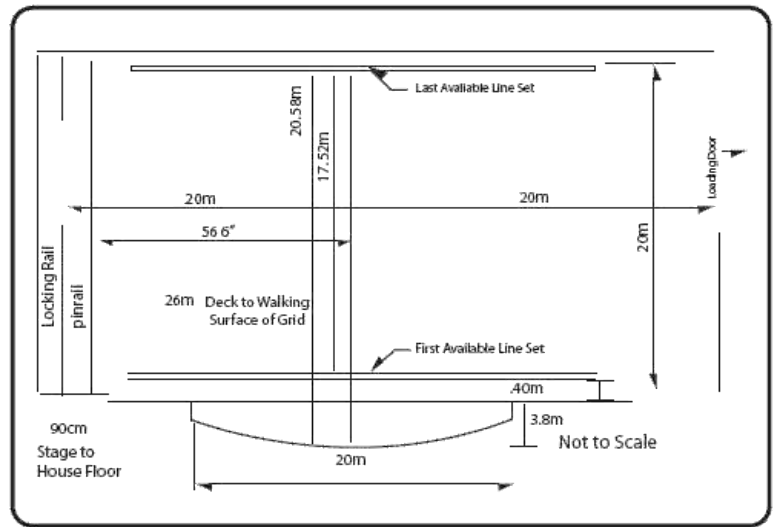

Dressing rooms & road staff rooms

5 Star DR Stage level 4.05x3.3m

1DR Normal Stage level 4.5x4.8m

2 Star DR One level above stage 4.05x3.3m

Chorus DR One level above stage 2x8m

Chorus DR One level above stage 2x8m

Multi Purpose DR One level above stage 4x3.5m

Green Room One level above stage 5.5x3.65m

Road Manager's Office Stage level 4x3.5m

Multi Purpose Room One level above stage 7.5x7.5m

Stage

Stage Width = 20m

Depth = 20m

Proscenium Width = 13.80m

Proscenium Height = 12.80m

Stage depth

Below the border to the last scenery line 18.55m

Stage height

Height from stage to ceiling = 22m

Height from floor to ceiling = 26m

Technical Specs

Orchestra pit

Orchestra Pit = 80 m²

Width = 3.93m

Depth from the center = 18.47m

Depth from the border = 2.47m

Power supply

(1) 400A, 3-phase 208 company switch isolated ground (stage left)

(1) 400A, 3-phase 208 company switch isolated ground (stage right)

(1) 200A, 3-phase 208 company switch isolated ground (stage left)

(1) 200A, 3-phase 208 company switch isolated ground (stage right)

Rigging system

Counterweight = 14,000 lbs.

Concerts / Shows:

- Height to top of rigging grid = 26m
- Main stage rigging grid = 20x40m
- Main beams 3m centers left to right
- Pulleys on 2.52m centers downstage to upstage
- Channel throughout grid on 4" centers downstage to upstage for virtually unlimited point access
- Forestage rigging grid = 12x20m
- Main beams on 3m centers

Line sets:

38 8-linesets, 100' batten, low + 8", height + 26m

Line sets are movable up to 8" up or downstage at grid

Fixed electrics 2.84m

Fly gallery with pin rail stage right at + 9.2m

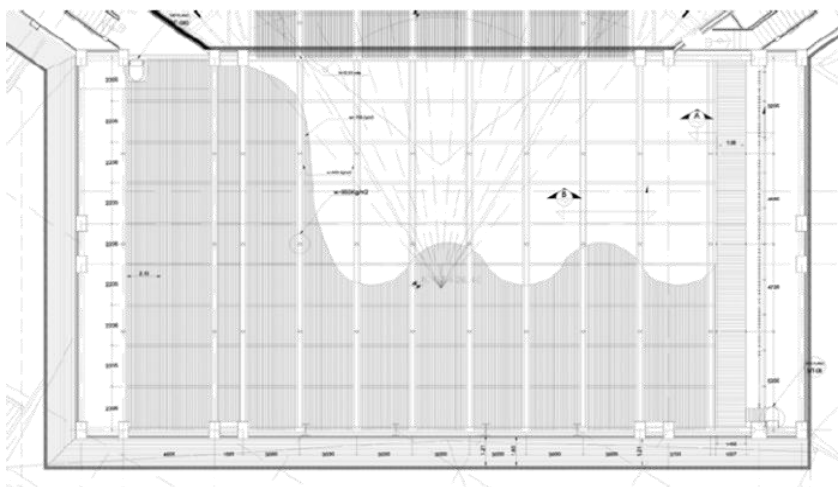

Allowable rigging loads

- A. Total allowable rigging load to stage gridiron = 241,406 lbs.
- B. Total allowable rigging load to forestage access grid = 78,402 lbs.
- C. Stage gridiron allowable rigging loads = 150 PSF to channels and purlins, 55 PSF to main beams and hangers, and 30 PSF total load to trusses. Dead hang loads allowed anywhere in these areas.

Technical Specs

Sound equipment

Console Yamaha PM1D FOH
Lexicon effects PCM 81
Digital Sound Platform BIAMP Audio FLEX 31X90
Feed Back SABINE SM820
Meyer Line Array

Monitors built in to each dressing room and backstage
Three channel Clearcom system with both normal and wireless capabilities
House Microphones Shure, Sennheiser, Audio Technica

House curtains

Main Curtain	12.45 x 12.00m
Border	22.00 x 3.00m
Leg	1.4 x 12.00m
Drop curtain	12.45 x 12.00m
Back curtain	12.45 x 12.00m
One piece cyclorama	22.00 x 12.00m
Black Gauze	22.00 x 12.00m
White Gauze	22.00 x 12.00m

Lightning

Control ETC Emphasis Control Expression 3,500 channel w/24 submasters
Folloswspots 4 Xenon super troupers (1 left, 2 center, 1 right)
Center: Throw to the stage
Balcony elevation at center follow spot = 100 m
Left Throw

Ellipsoidal spotlight

20 Ellipsoidal 5°	(6") 575 watts
20 Ellipsoidal 10°	(6") 575 watts
46 Ellipsoidal 19°	(6") 575 watts
32 Ellipsoidal 26°	(6") 575 watts
16 Ellipsoidal 5°	(6") 750 watts (plan convexo)

Reflector for cycloram

PAR 64 fixtures
Reflector for cycloram/ 8 reflectors /
(1000 watts)
Reflector 50 st par (750watts)

Contact Information

Aran Rush
General Manager
Mundo Imperial Expo & Forum
Blvd. de las Naciones y Blvd. Barra Vieja
Acapulco, Gro. México 39900
MEX. +52 (744) 466.33.22
U.S. +1 (718) 418 .4000
aran.rush@mundaimperial.com

Marcela Altamirano
Sales Director
Expos • Groups • Conventions
Av. Presidente Mazaryk 211
Col. Chapultepec Morales
CP 11560 México, D.F.
MEX. +52 (55) 52.81.00.57
marcela.altamirano@mundaimperial.com

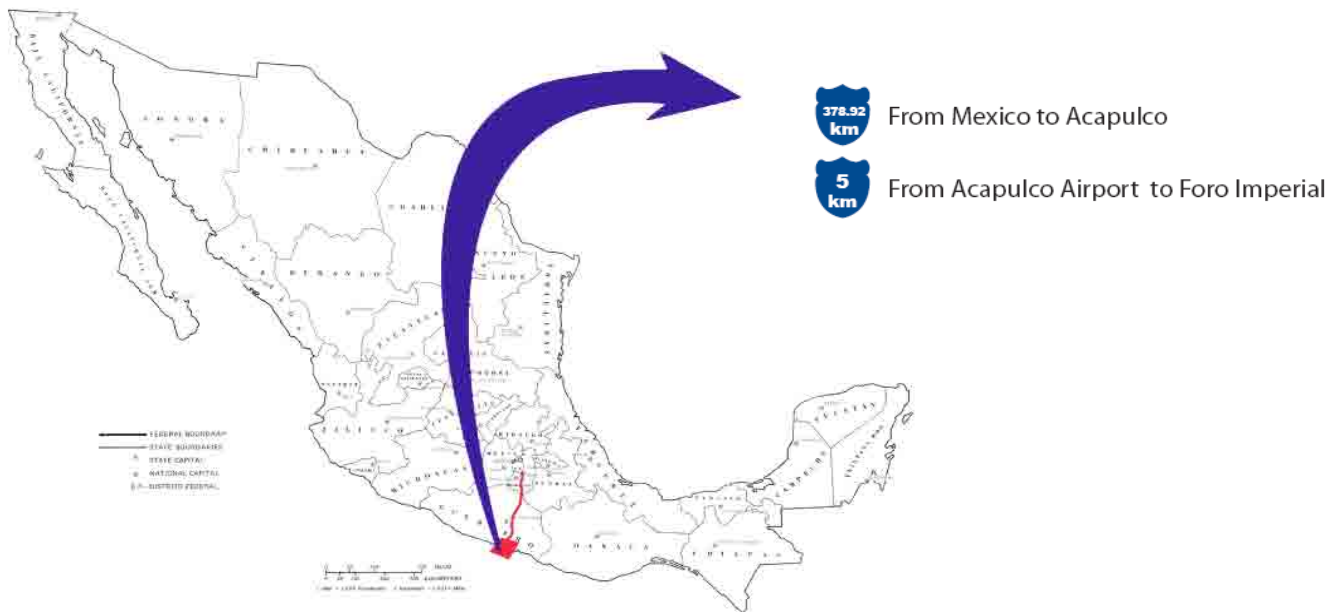



EXPO•FORUM•RESORT•SPA•PROMENADE